



VAC N Pull

GAT-VP-100



ESPAÑOL / PORTUGUÊS / FRANÇAIS / ITALIANO / ENGLISH / DEUTSCH

WORKSHOP EQUIPMENT AND ACCESSORIES		
User and maintenance manual	VAC N Pull GAT-VP-100	

THE UNDERSIGNED COMPANY:



RESERVES THE OWNERSHIP OF THIS MANUAL, PROHIBITS ITS REPRODUCTION AND DISTRIBUTION TO THIRD PARTIES WITHOUT THE AUTHORISATION OF THE OWNER AND RESERVES THE RIGHT TO PROTECT ITS RIGHTS, SUING VIOLATORS IN ACCORDANCE WITH THE LAW

This manual is an integral part of the machine and must be stored in a suitable manner to ensure its integrity and consultation throughout the life of the machine.
Further reproductions of this instruction manual are available on request:



2101 S. Water St.
Burnet, Texas. 78611

GradeAtools.com
info@gradeatools.com

ENGLISH

FILL IN THE DATA INDICATED ON THE IDENTIFICATION LABEL OF THE MACHINE

REGISTRATION NUMBER	<input type="text"/>	MODEL	<input type="text"/>
AIR PRESSURE (BAR)	<input type="text"/>	YEAR OF CONSTRUCTION	<input type="text"/>
PULLING FORCE (KG)	<input type="text"/>		

DATA RELATING TO THE DELIVERY OF THE MACHINE:

DELIVERY DATE

CUSTOMER

NOTES

INDEX

1. Introduction.
2. Identification of the equipment.
3. Essential health and safety requirements.
4. Instructions for use.
5. Precautions.
6. Maintenance and repair.
7. Homologation
8. Spare parts.

WORKSHOP EQUIPMENT AND ACCESSORIES		
User and maintenance manual	VAC N Pull GAT-VP-100	

1 – INTRODUCTION

This manual is intended for the personnel who are responsible for safety in the company and for the person who uses the equipment, so you should read carefully all the information it contains.

The manual contains characteristic data of the equipment, instructions for its proper use and the specific use of the machine.

The manual must be kept with the machine and must be available for any eventuality, malfunction or check.

	READ THE MANUAL CAREFULLY BEFORE USE.
---	--

2 – IDENTIFICATION OF THE EQUIPMENT

The Fast Puller equipment is designed to carry out sheet metal repairs on vehicles and/or similar, consisting of a portable pulling system that is fixed to the ground by means of a vacuum system using an ejector.

The puller base with vacuum system is the indispensable complement for dent removal work. The 250 kg pulling force, controlled by a ratchet system, provides the necessary pressure for each repair. The base is fixed to the floor by means of a pneumatic vacuum system, allowing full mobility throughout the workshop. The tower is dismountable and has different adjustment positions so that the draught can be adjusted as much as possible to the needs of the repair. Its aluminium structure makes it light and easy to transport.

For transport, it has two rear wheels and handles, so that by resting the wheels on the ground, the puller can be moved easily and effortlessly.

The Fast Puller equipment is identified by a CE label placed on the equipment, which identifies each machine individually. In case of any anomaly with the machine, please contact MARTECH's technical department by referring to the data on the equipment's label.



VAC N Pull
GAT-VP-100

3 – ESSENTIAL HEALTH AND SAFETY REQUIREMENTS

The correct operation of this equipment is subject to the correct connection of the different parts that make it up.

These operations must be carried out by trained and experienced personnel.

The manufacturer is not responsible for the safety of the equipment if the instructions for use, ordinary and extraordinary maintenance and repair in this manual are not followed, or if the equipment is used for other purposes.

	WARNING! For your safety, read this manual carefully.
---	--

Be very careful, as incorrect handling can cause serious damage to materials and persons.

	WARNING! The maximum tightening torque of the screws is 20 Nm.
---	---

The necessary precautions for use and safety are listed below:

- As this equipment exerts traction on an element, it is important not to stand behind the equipment to prevent damage caused by the release of the chain at the moment of exerting the 250kg traction, as in this case the element will come out in the opposite direction to the force.
- To ensure a correct suction force to the ground, it is necessary that the area is clean (dust, liquids or other elements) and without cracks to guarantee the correct sealing of the rubber.
- The equipment has two rear wheels for transport and mobility, for which it is necessary to tilt the column and operate it from the handles designed for this purpose. In case the displacement is not carried out correctly, the lower rubber of the base could be damaged.
- The equipment requires compressed air supply for its operation (recommended operating pressure 4 bar). Check that the base is fixed.

	WARNING! Always use with compressed air connected. Always check the air connection before unscrewing the sheet metal, otherwise the floor fastening will not be secured.
---	--

- If the equipment will operate without compressed air, Grade A Tools is not responsible for any damage to persons, materials or other items in the vicinity.

4 – INSTRUCTIONS FOR USE

All the following operations must only be carried out by trained and qualified personnel.

Failure to comply with the provisions below, or tampering with the pneumatic connections, exempts the manufacturer from any liability for non-compliance or damage caused by malfunctioning of the equipment.

The following are the steps to follow for the proper use of the Fast Puller equipment.

- 1) By means of the wheels and handles located on the column, the equipment can be moved to the work area (previously clean and free of cracks) to be able to exert the traction force.
- 2) Once located at the distance and position that the operator considers appropriate (as straight as possible and as close to the repair), the air intake is connected so that the vacuum ejector can work on the base of the ELE, exerting sufficient pressure to immobilise the equipment.
- 3) The height adjustment of the traction shall be carried out in such a way that the traction throw is always as straight as possible or, failing that, according to the operator's experience. This adjustment is made by raising or lowering the coupling of the hoist intended to exert traction. For this adjustment, the column or tower of the ELE has multiple holes for the placement of the hoist coupling.
- 4) The pulling force is exerted by the hoist that will pick up the chain by means of a ratchet system that the operator can operate with the handle designed for this purpose. The hoist has a reversible system so that once the traction force has been exerted, it can be released by turning the piece with reversibility.
- 5) The traction force required will depend on the repair to be carried out with the limitation of 250kg, which is that exerted by the hoist. A higher pulling force could damage the mechanism or cause the base to lose its vacuum, resulting in the possible overturning of the base.

	WARNING! Always use this system for pulling forces of less than 250kg.
---	---

5 – PRECAUTIONS

All the following operations must be carried out only by trained and qualified personnel. Failure to comply with the provisions below, or tampering with the pneumatic connections, exempts the manufacturer from any liability for non-compliance or damage caused by malfunctioning of the equipment.

The following instructions must be observed by the operator.

- The base does not empty sufficiently due to poor sealing of the base or rubber, excessive force or failure of the compressed air supply or ejector. In such a situation the ELE will lose its hold and may fall in the direction of the force being exerted. According to the tests carried out, the ELE never tips over as the base prevents it from doing so and it returns to its original position.

	WARNING! Make sure that the base is fixed to the floor before removing the sheet metal.
--	--

- The traction chain may come loose while pulling. In such a situation the chain will reprocess, which can be dangerous if the operator is positioned in the opposite direction of the pull.

	WARNING! When pulling the chain, no persons or materials should be placed around the equipment.
---	--

6 – MAINTENANCE AND REPAIR

All maintenance and repair work must be carried out by trained personnel who have read this manual and the operating instructions.

The following are recommendations for possible repairs to the machine.

The machine should be located in a place that is preferably flat, free of scratches, cracks and cracks, and as clean and dust-free as possible.

The rubber that acts as a sealant should be checked to ensure that it is watertight when the vacuum is applied.

WORKSHOP EQUIPMENT AND ACCESSORIES		
User and maintenance manual	VAC N Pull GAT-VP-100	

If it is in poor condition, always use original consumables to ensure correct operation of the equipment.

If the problem persists, call the Grade A Tools technical assistance service.

Check the condition of the chain and its fasteners before exerting traction forces on them. In case of damage or wear, always use original consumables to ensure correct operation of the equipment.

WORKSHOP EQUIPMENT AND ACCESSORIES		
User and maintenance manual	VAC N Pull GAT-VP-100	



EC DECLARATION OF CONFORMITY

WE  **Grade A Tools®**
2101 S. Water St.
Burnet, Texas. 78611
GradeAtools.com
info@gradeatools.com

DECLARE UNDER OUR SOLE RESPONSIBILITY THAT THE PRODUCT:

FAST PULLER

REGISTRATION NUMBER: _____

TO WHICH THIS DECLARATION REFERS, IS IN CONFORMITY WITH AND THEREFORE APPLICABLE TO THE FOLLOWING STANDARDS, AND THEIR SUCCESSIVE EXTENSIONS OR MODIFICATIONS:

ROYAL DECREE 1644/2008, of 10 October, establishing the rules for the marketing and putting into service of machinery.

LAW 21/1992, of 16 July, on Industry.

DIRECTIVE 2006/42/EC, of the European Parliament and of the Council, of 17 May 2006, relating to machinery and amending Directive 95/16/CE (Recast).

ROYAL DECREE 2060/2008, of 12 December, approving the pressure equipment regulation and its complementary technical instructions.

The coupling of this machine of the present declaration of conformity to any machine that does not comply with the provisions of Directive 2006/42/EC, as well as other successive or subsequent modifications, is prohibited.



2101 S. Water St.
Burnet, Texas. 78611

GradeAtools.com
info@gradeatools.com

ENGLISH

8 – SPARE PARTS

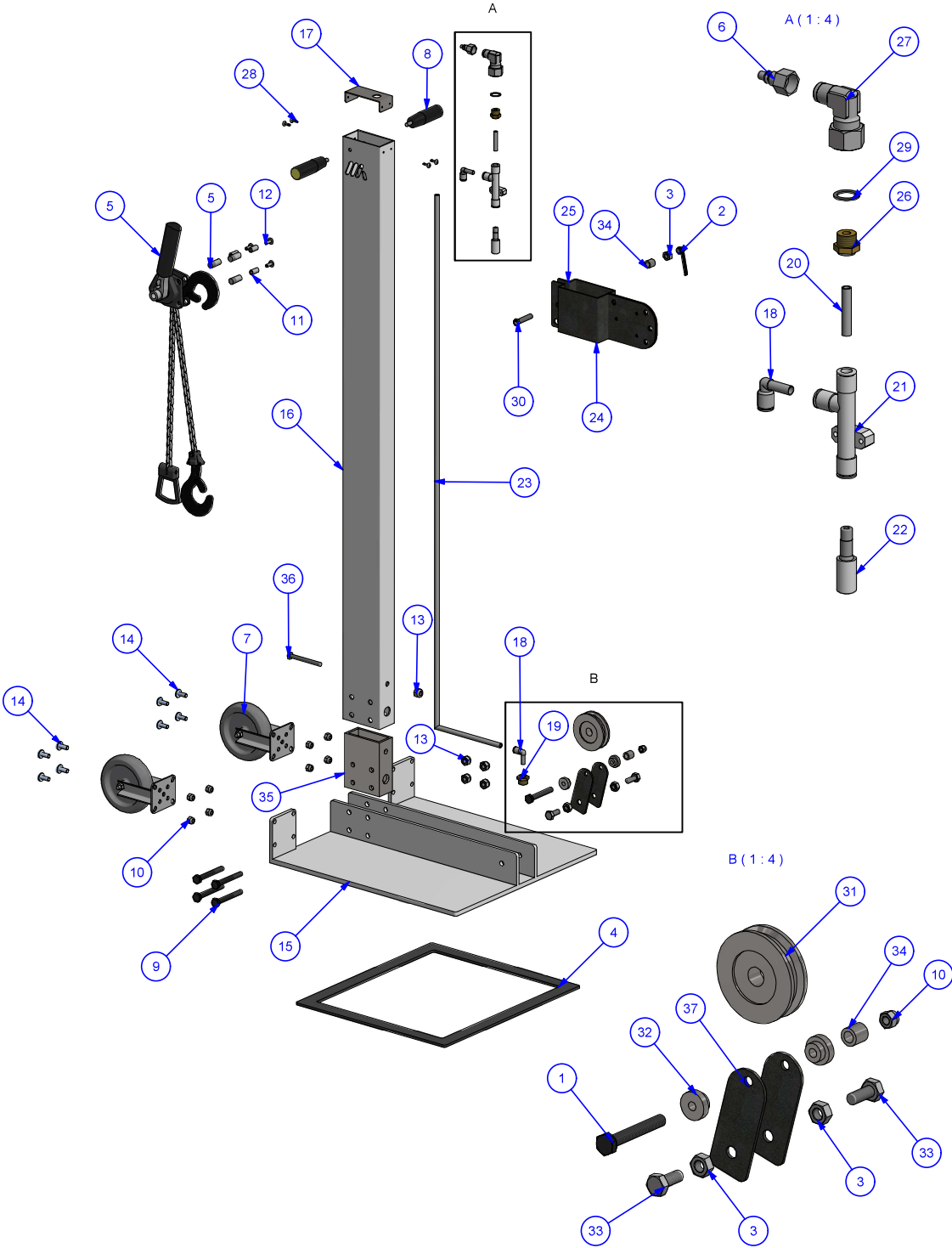

WORKSHOP EQUIPMENT AND ACCESSORIESUser and maintenance
manual**VAC N Pull**
GAT-VP-100

No.	Code	Quantity	Description
1	FL01P003	1	ZINC PLATED HEXAGON SOCKET HEAD CAP SCREW DIN 933 M8X60
2	FL01P039	1	FEMALE NYLON PRESSURE PULLER M10
3	FL01P040	3	3 TOOTHED LOCKING FLANGE NUT ZINC DIN6923 M8
4	SP551902	1	RUBBER FLOORING
5	SP706334	1	PRECISION PULLER KIT FOR MINI-PULL PRO
6	ZZL005P54	1	3/8" QUICK PLUG
7	ZZL005P58	2	WHEELS FOR "L" PULLING
8	ZZL005P59	2	FIXED HANDLE M8X10
9	ZZL006P71	4	QUALITY SCREW 12-9 M M10x80
10	ZZL006P73	9	LOCKING NUT DIN 985 M-8 ZINC PLATED
11	ZZL006P77	3	ROUND METAL ROD UNION SLEEVE M6x20
12	ZZL006P78	3	SCREW 6X16 mm (washer)
13	ZZL006P80	5	LOCKING NUT M10 ZINC PLATED C.8
14	ZZL008P74	8	ALLEN SCREW 7380-2 (washer) 8X20 ZINC PLATED
15	ZZL08P02A	1	BASE
16	ZZL08P22E / ZZL08P102C	1	ALUMINIUM PIPE 100X50X3 (1300 mm / 1700 mm)
17	ZZL08P26B	1	TUBE COVER
18	ZZL08P94A	2	D10 PIPE-PLUG ELBOW CONNECTOR
19	ZZL08P96A	1	HEXAGONAL CONNECTOR STRAIGHT D10 Rc 1/2
20	ZZL08P97A	1	D8 CONNECTOR
21	ZZL08P98A	1	VACUUM EJECTOR D8-D10-D10
22	ZZL08P99A	1	MUFFLER FOR D10 TUBE
23	ZZL08P100A	1	POLYURETHANE TUBE D10 GREY X METRE
24	ZZL08P104F	1	SUPPORT KIT RIGHT PULLING RACK
25	ZZL08P105G	1	SUPPORT KIT LEFT PULLING RACK
26	ZZL09P106	1	D8 M 3/8" MALE CONNECTOR
27	ZZL09P107	1	ELBOW M 3/8" F-M
28	ZZL09P108	4	DRILL TIP SCREW 3,5 x 9,5
29	ZZL09P111	1	D17 WASHER
30	ZZL10P115	1	ZINC PLATED HEXAGON SOCKET HEAD CAP SCREW DIN933 M10X45
31	ZZL10P109	1	FAST PULLER POLE (80X20)
32	ZZL10P112	2	FAST PULLER PULLEY INNER BUSHING (2 PARTS)
33	ZZL10P113	2	HEXAGONAL SCREW ZINC PLATED WITH WASHER DIN6921 M10X20 ALL THREADED
34	ZZL10P114	2	SPACER SLEEVE DINT10XDEXT16X16H
35	ZZL10P117	1	INNER TUBE REINFORCEMENT SLEEVE
36	ZZL10P118	1	HEXAGONAL SCREW DIN933 M10X110 ZINC PLATED
37	ZZR01P03A	2	PULLEY SUPPORT PLATE

ESPAÑOL / PORTUGUÊS / FRANÇAIS / ITALIANO / ENGLISH / DEUTSCH



2101 S. Water St.
Burnet, Texas. 78611

GradeAtools.com
info@gradeatools.com



VAC N. Pull

GAT-VP-100

